

STEP 4

Wrap the paper cutter(8) around the footboard.

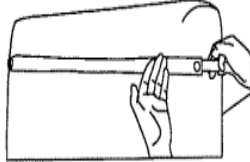

STEP 5

Place the headrest(7) on the couch and fasten straps to the under sides of the couch.

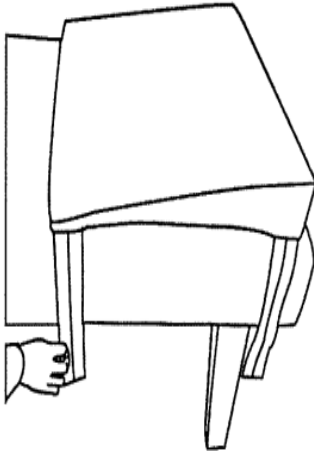

CARE AND MAINTENANCE

- General cleaning:** Remove daily dirt and grime from the couch with a mild soap and warm water solution, and dry with a soft lint-free cloth.
- Daily cleaning:** Remove daily dirt and grime from the couch with a mild soap and warm water solution, and dry with a soft lint-free cloth.
- Disinfecting:** Disinfect the couch as required, with an isopropanol based hospital grade disinfectant cleaner.
- Stain removal:** Some minor stains can be removed with a mild non-abrasive cleaner. Spray a damp cloth with cleaners and gently wipe to remove stain, rinse thoroughly with warm water, and dry with a soft lint free cloth.
- Wood care:** Your recovery couch is made of selected hardwood. Keep the couch dry, and avoid exposure to wet or humid environments.



Recovery Couch

- Wooden Legs Assembly Instruction

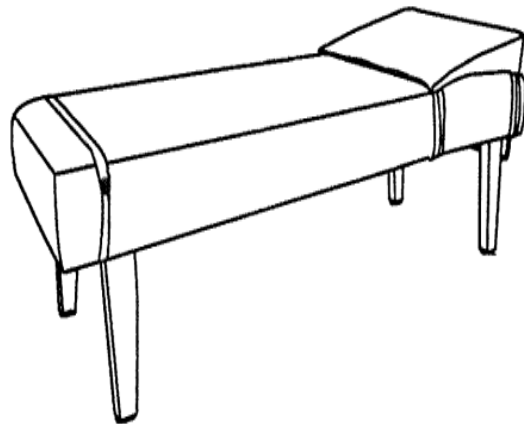

Please follow these instructions to assemble your new Recovery Couch. This item has been skillfully crafted to exacting standards, utilizing high quality components and materials. Your Recovery Couch is "environmentally friendly" and PVC-free. All upholstery covering is CAL01350 compliant. With proper use and care, as outlined in this user guide, your Recovery Couch should provide a longtime reliable performance. To insure the safe and correct use of your Recovery Couch, please take a moment to read this entire guide first.

PARTS

Remove all parts from the box and position them in front of you.
Read the assembly instructions carefully before proceeding.
Do not dispose of packing materials until assembly is completed.

| Part No. | Description | Qty |
|----------|-----------------------|-----|
| 1 | The body of the couch | 1 |
| 2 | Wooden legs | 4 |
| 3 | Allen head screws A | 16 |
| 4 | Allen head screws B | 2 |
| 5 | Washer | 18 |
| 6 | Paper roll holder | 1 |
| 7 | Headrest | 1 |
| 8 | Paper cutter | 1 |
| 9 | Allen wrench | 1 |

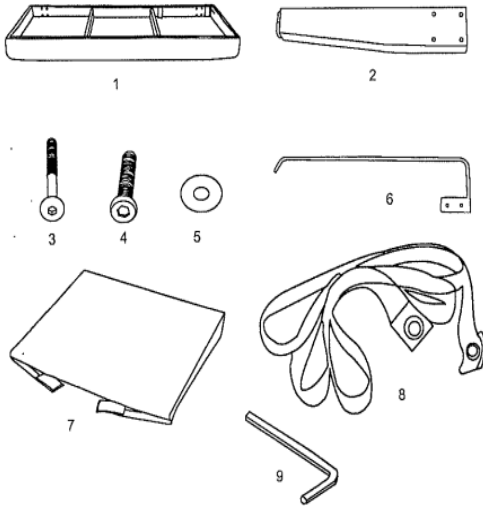

ASSEMBLY AND INSTALLATION INSTRUCTIONS

STEP 1

Place the body of the couch(1) upside down on a flat surface.

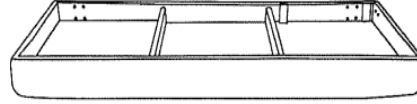

STEP 2

Use the allen head screws B(4), washers(5) and allen wrench (9) to fasten the paper roll holder(6) to the head of the couch, where the headrest(7) will be attached. Make sure they are tightened.

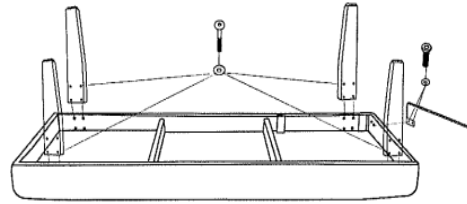

STEP 3

Fasten four wooden legs(2) at the four corners of the couch board by using allen head screws A(4) and washers(5). Make sure the screws are tightened with allen wrench.



NO POWER TOOLS